

# TKC TKC Connection ISO 2852

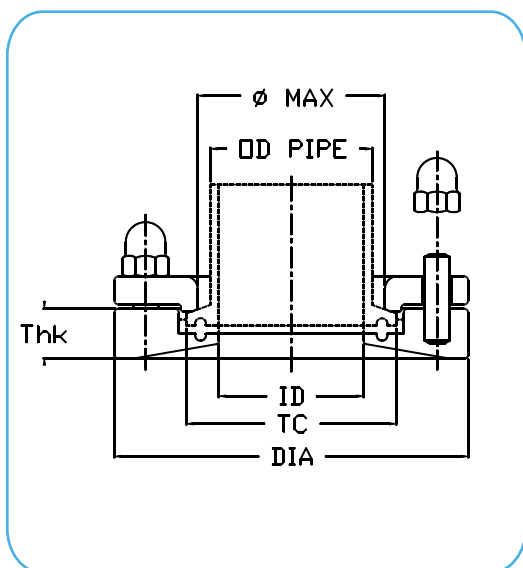

CODE	Size DN	ØTC	ID	OD pipe	Ømax	DIA	Thk std (mm) #	Thk (mm) #	Thk (mm) #	Thk (mm) #	Bolts
TKC-HC0#-12A	08	25	10.3	13.5	20	55	15	25	38	51	4 x M6
TKC-HE0#-12A	10	25	14	17.2	20	55	15	25	38	51	4 x M6
TKC-HG0#-12A	15	50.5	18.1	21.3	45	85	17	25	38	51	4 x M8
TKC-HH0#-12A	20	50.5	23.7	26.9	45	85	17	25	38	51	4 x M8
TKC-HJ0#-12A	25	50.5	29.7	33.7	45	85	17	25	38	51	4 x M8
TKC-HL0#-12A	32	64	38.4	42.4	57	100	17	25	38	51	4 x M8
TKC-HM0#-12A	40	64	44.3	48.3	57	100	17	25	38	51	4 x M8
TKC-HN0#-12A	50	77.5	56.3	60.3	71	112	17	25	38	51	4 x M8
TKC-HO0#-12A	65	91	72.1	76.1	85	130	20	25	38	51	6 x M8
TKC-HP0#-12A	80	106	84.3	88.9	93	146	20	25	38	51	6 x M8
TKC-HR0#-12A	100	130	109.7	114.3	117	170	20	25	38	51	8 x M8

## Technical Information:

**Tri-Clamp Connections:** according to ISO 2852 / DIN 32676 - REIHE B

**Welding Flange Material:** AISI 316L – 1.4404 | *on request 1.4435 or other special steels* |

**Locking Ring Material:** AISI 316L – 1.4404

**Bolts and Nuts Material:** AISI 304 – 1.4301

**Internal Surface Finish:**  $Ra \leq 0.5 \mu m$  → code **12** e.g.: TKC-HC015-**12A**

**Optional:** For customized TKC-H Connections, please contact us.

## Specifications:

**Regulatory:** designed according to PED 2014/68/EU directive, ASME VIII Div.2 and F.E.M. (Finite Element Method) calculated, approved and certified by notified body.

**Design Pressure:** 7 barg (101,5 psig)

**Design Temperature:** -80°C to 200°C (-112°F to 392°F)

Note: The applied gasket (not included) may have different design temperature and/or pressure limits than the TKC. The weakest component in the assembled product determines the maximum design temperature and pressure limits.

**Marking:** Each TKC Connection is marked with serial number for full lot traceability.

### CONFIGURATOR



### DATASHEETS



Last updates can be found on our website - [www.aerreinox.it](http://www.aerreinox.it)  
In the interests of development of the product, we reserve the right to change the specifications without prior notice